



INSTALLATION GUIDE

Single 52mm Vent Gauge Pod for 2020–2025 Subaru Outback

Installing your 52mm vent gauge pod mount is detailed below and takes about 15-20 minutes.



1 Carefully use an interior panel removal kit, a small flathead screwdriver, or a knife to insert in this area of the vent nozzle and dashboard. Gently pry up the vent nozzle and it will release from the dashboard.



2 There is an opening in the back of the gauge pod to run the wires/lines from the 52mm gauge.

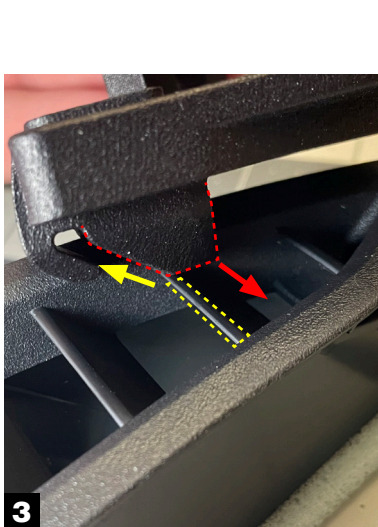

3 Place your gauge pot mount on the vent nozzle as shown above, sliding the defroster vent fin (in yellow above) into the slot of the mount.

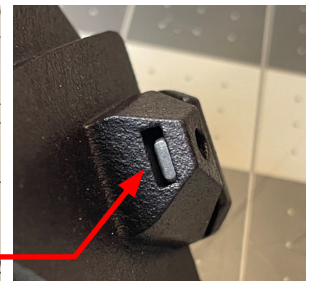
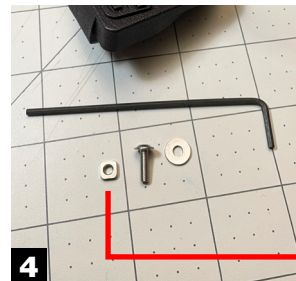

With the mount in place, turn everything upside down and take the supplied square nut and insert it into the small rectangular slot. Next, use the included hex wrench to fasten the screw and washer into the captured square nut, through the opening in the vent. Reinstall the vent nozzle with the new mount back into the dashboard to complete the installation.